

About Our Maps: Navigating the Lane County Assessor Map Collection

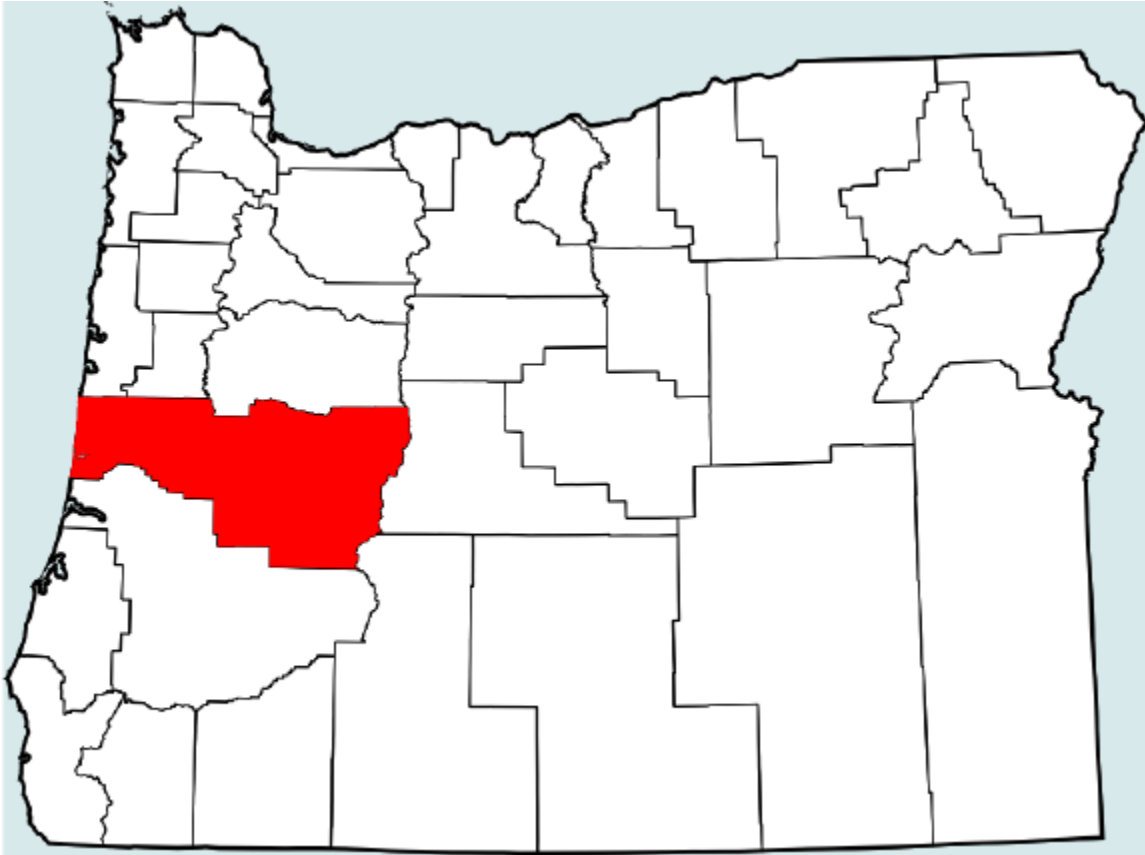

TABLE OF CONTENTS

- 1 TITLE PAGE
- 2 CARTOGRAPHY MAP INFORMATION
- 3 LOCATION/MAP NAME SEARCH
- 4 MAP NUMBERING SYSTEM
- 5 ANATOMY OF A TAX MAP
- 6 MAP SCALE
- 7 DETAIL OF A SECTION OF LAND
- 8 EAST RANGE NUMBERING
- 9-11 INDEX TO CITIES AND LOCALES

Cartography Map Information

Cartography manages a collection of approximately 3600 assessor maps. These maps have gone through several transitions as cartographic technology changes. In 2013 the Cartography unit completed a multiyear effort to convert the Computer Aided Drafting (CAD) format maps to Geographic Information System (GIS) format maps. The GIS format is consistent with a state wide effort (ORMAP) to normalize all assessor map data.

The Lane County map numbering system is based on the Public Land Survey System. The principle of this system is the division of the State of Oregon into a six mile grid of Township and Range lines in the four quadrants defined by the Willamette Meridian and the Oregon Base Line. The resulting 36 square mile townships are further subdivided into 36 Sections and subsequent Quarter Sections. The map title refers to a specific location within the system.

FOUR QUADRANTS OF THE U.S. RECTANGULAR SURVEY SYSTEM

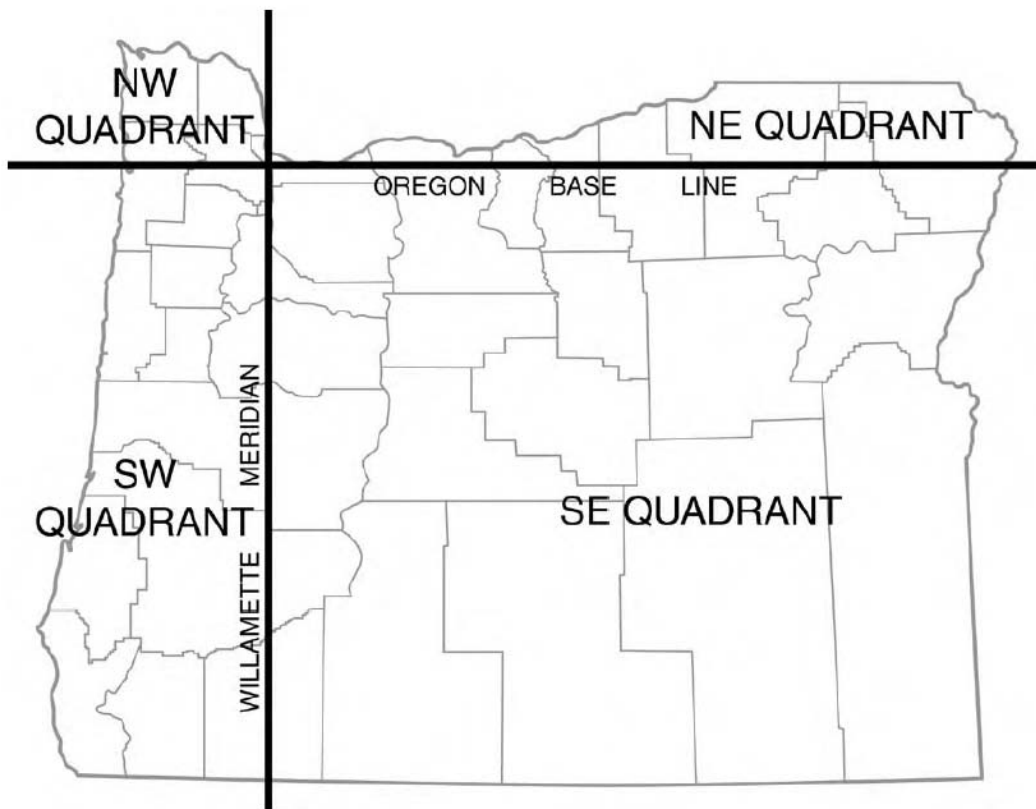

The following disclaimer is included on our Real Property Tax Lot Records:

"In preparation of these records, every effort has been made to offer the most current, correct, and clearly expressed information possible. Nevertheless, inadvertent errors in information may occur. In particular but without limiting anything here, Lane County disclaims any responsibility for typographical errors and accuracy of this information. The information and data included on Lane County servers have been compiled by Lane County staff from a variety of sources, and are subject to change without notice to the User. Lane County makes no warranties or representations whatsoever regarding the quality, content, completeness, suitability, adequacy, sequence, accuracy, or timeliness of such information and data." "The legal descriptions contained herein are for tax lot purposes only."

Location Search

In the Address field enter the house number and street name. Use abbreviations for street directions (North=N, East=E, South=S, West=W) and street types.

Correct: 125 E 8th Ave

Incorrect: 125 East 8th Avenue

You can enter any part of an address in a search. For example 125 E 8th Ave could be searched for using: 125 E or E 8th or 8th Ave. You can use the City dropdown menu to narrow your search results.

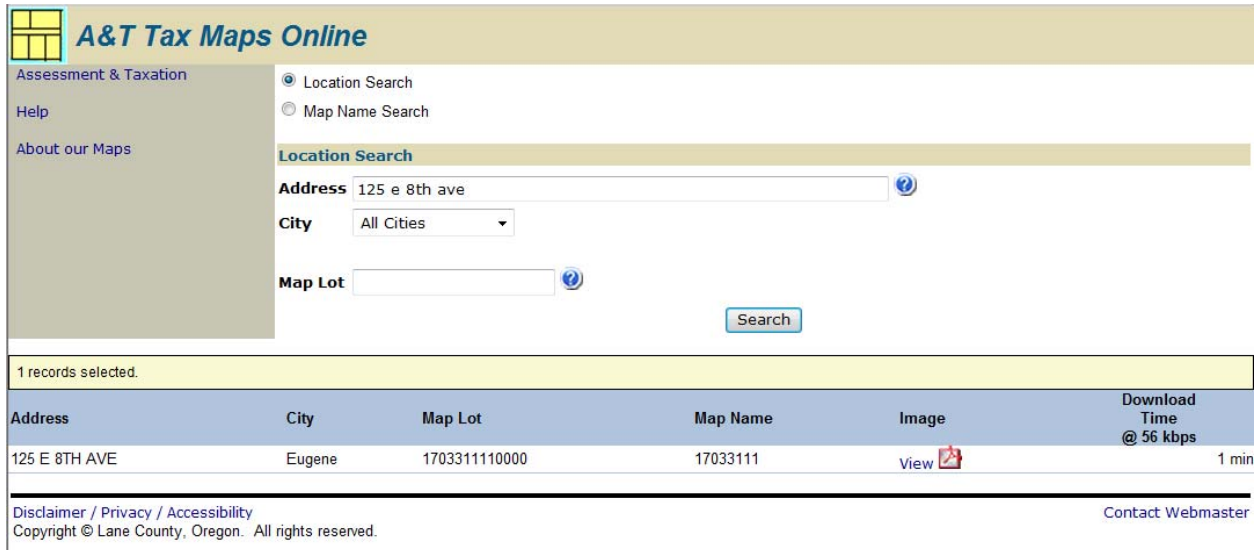

The screenshot shows the 'A&T Tax Maps Online' website. On the left is a navigation menu with 'Assessment & Taxation', 'Help', and 'About our Maps'. The main content area has two search options: 'Location Search' (selected) and 'Map Name Search'. Under 'Location Search', there are three input fields: 'Address' with '125 e 8th ave', 'City' with a dropdown menu set to 'All Cities', and 'Map Lot'. A 'Search' button is located below these fields. Below the search area, a yellow bar indicates '1 records selected.' A table displays the search results with columns: Address, City, Map Lot, Map Name, Image, and Download Time. The first row shows '125 E 8TH AVE', 'Eugene', '1703311110000', '17033111', a 'View' link with an image icon, and '1 min' download time. At the bottom, there is a footer with 'Disclaimer / Privacy / Accessibility' and 'Copyright © Lane County, Oregon. All rights reserved.' on the left, and 'Contact Webmaster' on the right.

Address	City	Map Lot	Map Name	Image	Download Time @ 56 kbps
125 E 8TH AVE	Eugene	1703311110000	17033111	View	1 min

Map Name Search

It is also possible to search by Map Name. The first 8 digits of Map Lot is the Map Name (or Map Number) and the last 5 digits represent the Taxlot Number. For example the Map Lot for 125 E 8th Ave is 1703311110000.

In the Map name field enter the 8 digit Map Number into the map name field

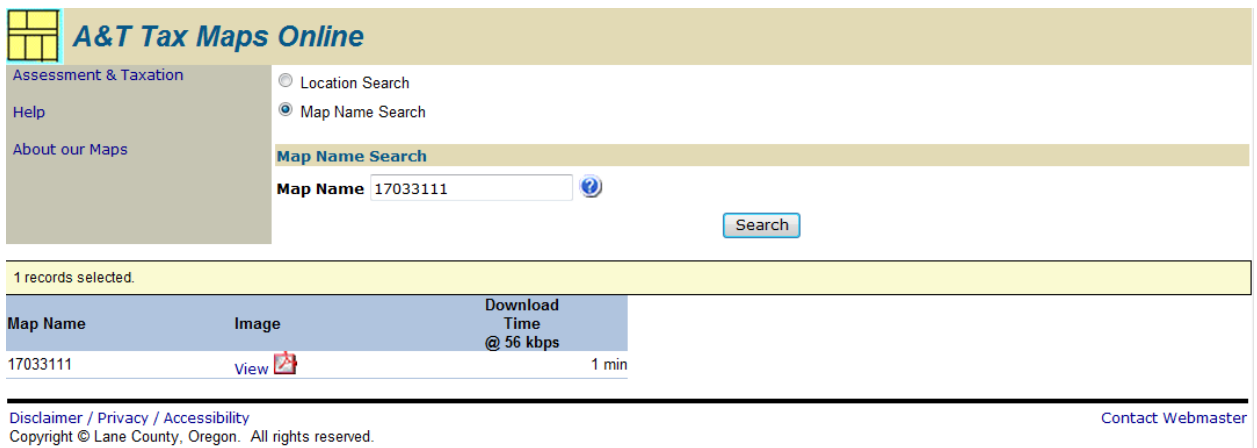

The screenshot shows the 'A&T Tax Maps Online' website. On the left is a navigation menu with 'Assessment & Taxation', 'Help', and 'About our Maps'. The main content area has two search options: 'Location Search' and 'Map Name Search' (selected). Under 'Map Name Search', there is one input field: 'Map Name' with '17033111'. A 'Search' button is located below this field. Below the search area, a yellow bar indicates '1 records selected.' A table displays the search results with columns: Map Name, Image, and Download Time. The first row shows '17033111', a 'View' link with an image icon, and '1 min' download time. At the bottom, there is a footer with 'Disclaimer / Privacy / Accessibility' and 'Copyright © Lane County, Oregon. All rights reserved.' on the left, and 'Contact Webmaster' on the right.

Map Name	Image	Download Time @ 56 kbps
17033111	View	1 min

Map Numbering System

The standard map number is based on the U.S. Rectangular Survey System (Township, Range, Section, 1/4 Section and 1/16 Section).

Map header reads as: **S.W. 1/4 S.E. 1/4 SEC. 36 T.17S. R.4W. W.M.**

1/16 SECTION 1/4 SECTION SECTION TOWNSHIP RANGE/SIDE OF WILLAMETTE MERIDIAN

Map number reads as: **17 04 36 4 3**

Township No. ↑
 Range No. ↑
 Section No. ↑
 1/4 Section No. ↑
 1/16 Section No. ↑

An illustration of where map 17043643 is in Lane County.

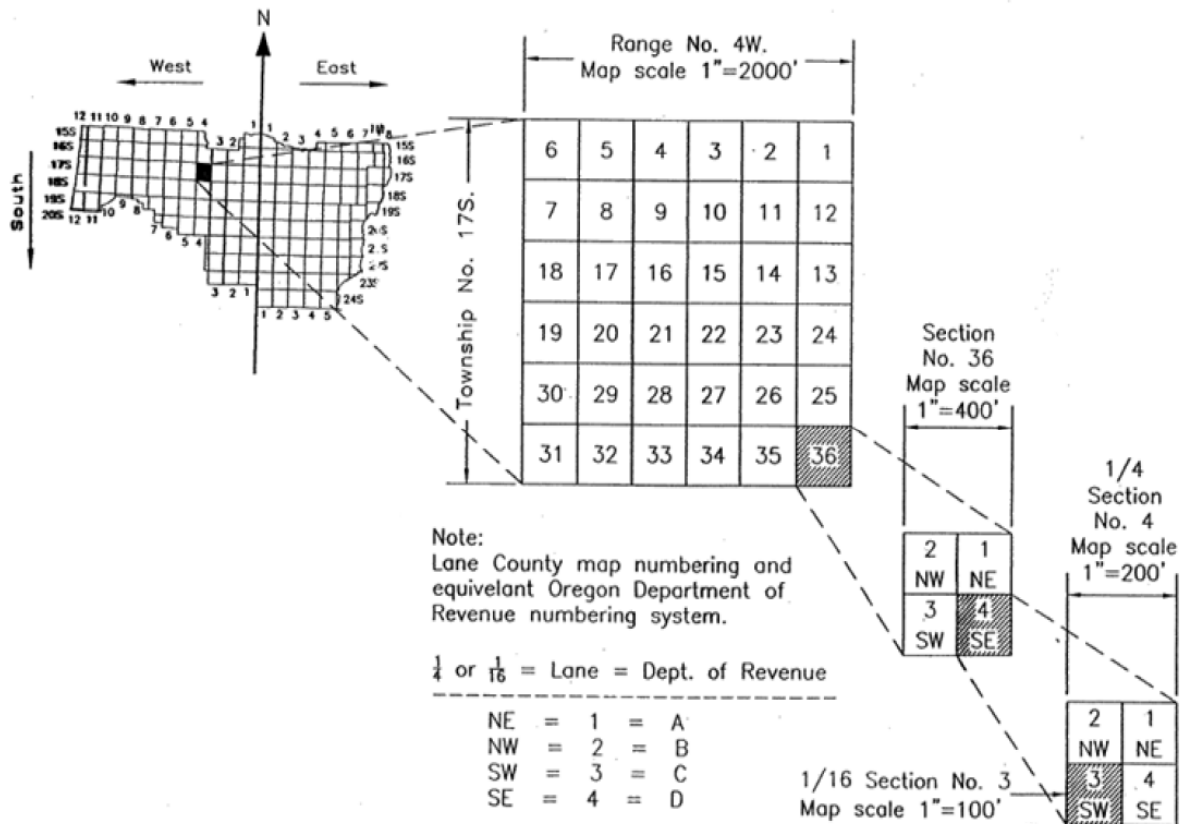

Map Scale

There are four standard map scales used in the cadastral map system. The map scale used is determined by the area being mapped, the quantity of detail to be shown, land use, and the number of parcels being mapped.

1"=2000'	One Township	e.g.) 21150000
1"=400'	One Section	e.g.) 18050100
1"=200'	One 1/4 Section	e.g.) 19120210
1"=100'	One 1/16 Section	e.g.) 17040123

Supplemental maps are an exception to the standard map scales and may be used to display condominiums in detail. Supplemental maps can be 1"=50' or 1"= 20' scale. These maps are distinguished from standard scale maps with S00# at the end of the map number (e.g. 17043634S001).

A Township is six square miles (more or less) and can be divided into 36 Sections. Each section is 1 square mile and 640 acres (more or less). Below is a picture of a township divided into sections. Sections can be divided into 1/4 Sections, and 1/4 Sections can be further divided into 1/16 Sections.

6	5	4	3	2	1
7	8	9	10	11	12
18	17	16	15	14	13
19	20	21	22	23	24
30	29	28	27	26	25
31	32	33	34	35	36

A section divided into 1/4 sections

2 (NW1/4)	1 (NE1/4)
3 (SW1/4)	4 (SE1/4)

A section divided into 1/16 sections

22	21	12	11
23	24	13	14
32	31	42	41
33	34	43	44

DETAIL OF A SECTION OF LAND

5280 FEET

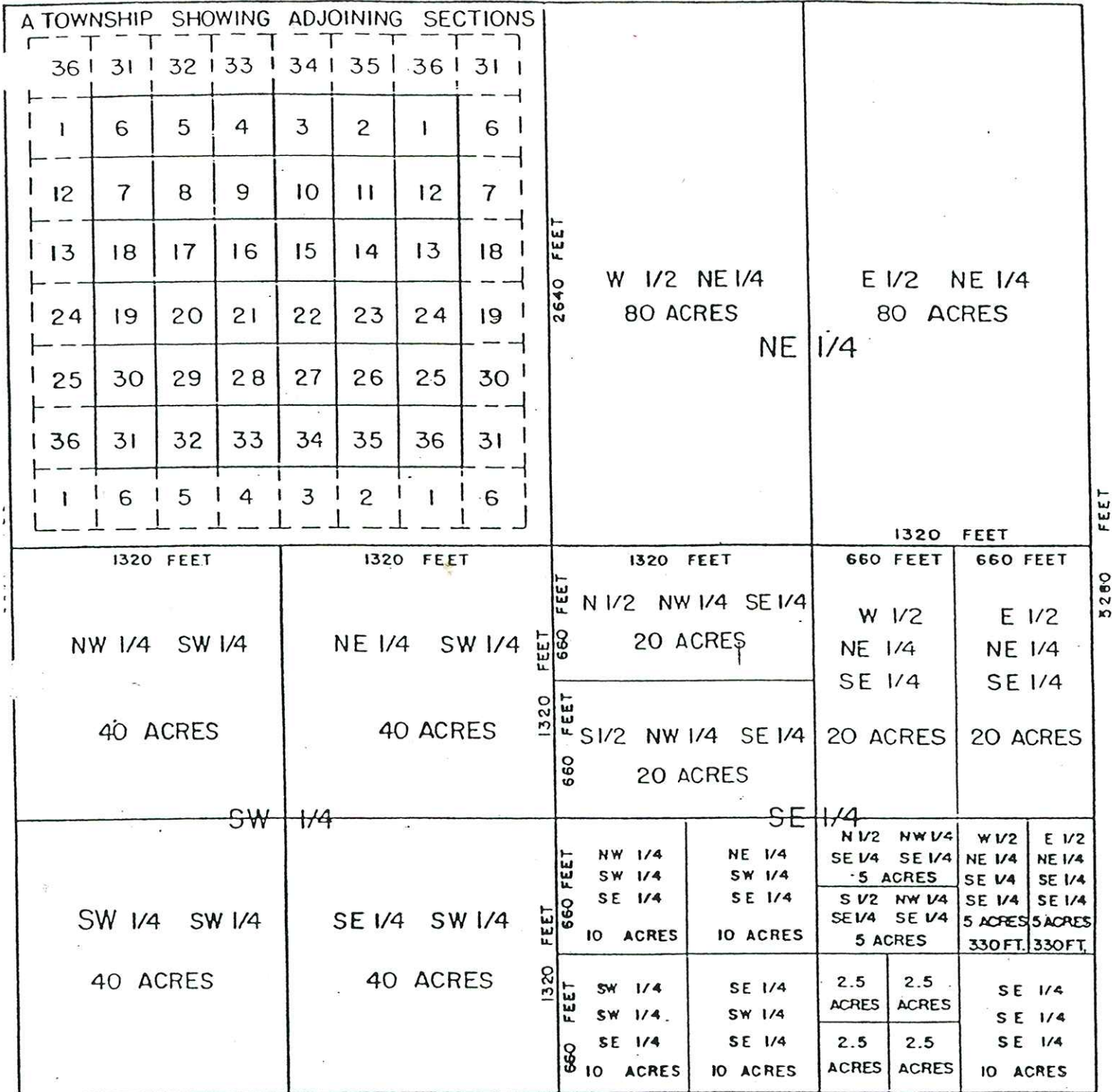

5280 FEET

LENGTH

- I LINK = 7.92 INCHES
- I CHAIN = 66 FEET = 100 LINKS
- ROD = 16.5 FEET = 25 LINKS
- MILE = 5280 FT. = 80 CHAINS

AREA

- I ACRE = 43,560 SQ. FT.
- I SEC. = 640 AC. = I SQ. MILE
- I TOWNSHIP = 36 SECTIONS
- I SQ. ACRE = 208.710 FEET SQ.

II 5A

East Range Numbering

In Lane County, the original computer system software would not accommodate letters in the map number, so “5” has been substituted for the letter “E” in eastern townships.

Lane County is divided by the Willamette Meridian. Ranges that are west of the Willamette Meridian are 2 digit numbers that start at 01 and increase by increments of 1 going west. Ranges that are east of the Willamette Meridian are also 2 digit numbers that start at 15 and increase by increments of 10 going east.

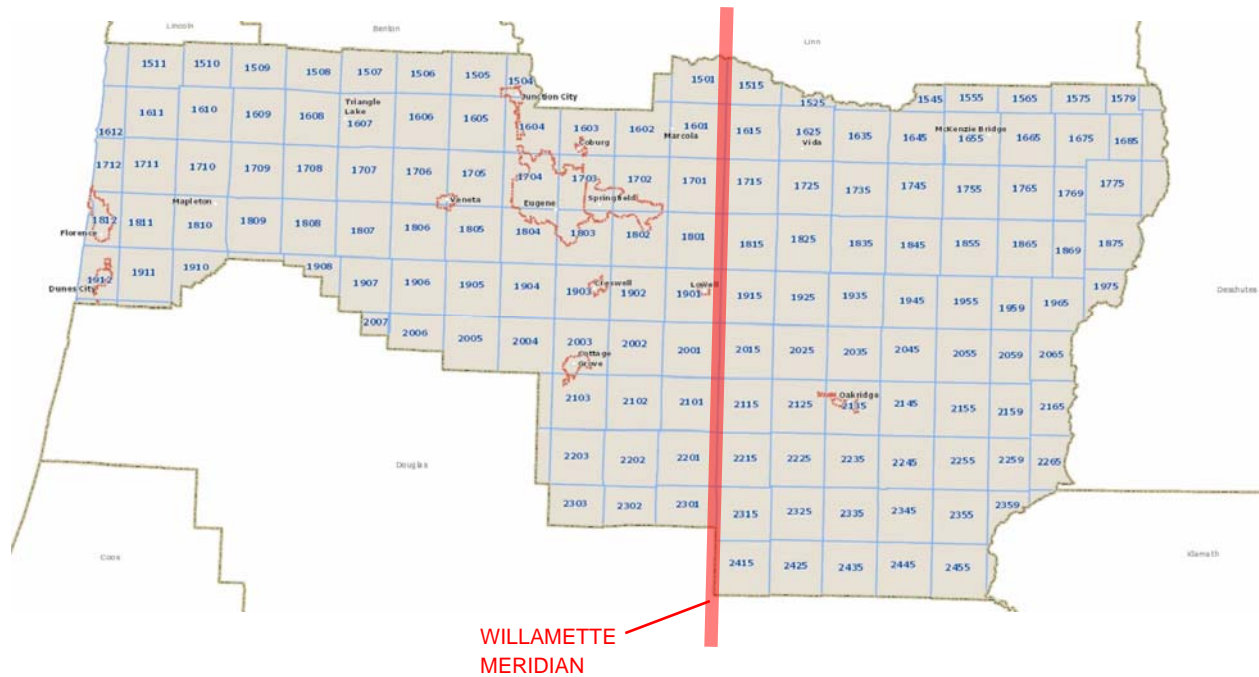

Index to Cities and Locales

INDEX TO MAP BOOKS BY CITY/LOCALE		
<p>Alvadore 160534 160535 170502 170503</p> <p>Blachly 160709</p> <p>Blue River 164520 164521 164528 164529</p> <p>Cheshire 160510 160515</p> <p>Coburg 160328 160329 160332 160333 170304</p> <p>Cottage Grove 200321 200322 200326 200327 200328 200329 200332 200333 200334 200335 210304 210305</p>	<p>Creswell 190310 190311 190312 190313 190314 190315 190323</p> <p>Crow 180518 180519</p> <p>Culp Creek 210130 210131 210132 210133 220105</p> <p>Cushman 181130</p> <p>Deadwood 170913 170914 170915 170916</p> <p>Dexter 190115 190116 190117 190120 190121</p> <p>Dorena 210130</p>	<p>Dune City 191200 191211 191213 191214 191215 191222 191223 191224 191226 191227 191234 201200 201203</p> <p>Elmira 170624 170625</p> <p>Eugene 160432 160433 160435 160436 170306 170307 170308 170309 170315 170316 170317 170318 170319 170320 170321 170322 170327 170328 170329 170330 170331 170332 170333 170401 170402 170403 170404</p>

Eugene (cont'd)	Eugene (cont'd)	Greenleaf
170405	180410	170804
170408	180411	170809
170409	180412	
170410	180413	Jasper
170411		180214
170412	Fall Creek	180223
170413	180133	
170414		Junction City
170415	Florence	150429
170416	171200	150430
170417	171233	150431
170418	181200	150432
170419	181203	150536
170420	181204	160405
170421	181209	160406
170422	181210	160408
170423	181211	160417
170424	181214	160420
170425	181215	160421
170426	181216	
170427	181222	Lancaster
170428	181223	150420
170429	181224	
170430	181226	Leaburg
170431	181227	171509
170432	181234	171510
170433	181235	
170434		Lorane
170435	Franklin	200512
170436	160521	200513
180303	160528	
180304		Lowell
180305	Glenada	190110
180306	181234	190111
180307	181235	190113
180308	191202	190114
180309	191203	190115
180310	191210	
180316	191211	Mapleton
180317		171035
180318	Goshen	181002
180319	180314	181011
180320	180323	
180321	180324	Marcola
180401	180325	160118
180402	180326	160119
180403		160213
180404		160224
180405		
180409		

<p>McKenzie Bridge</p> <p>165513 165514 165523 166518</p> <p>Nimrod</p> <p>173502 173503 173510 173511</p> <p>Noti</p> <p>170629 170630</p> <p>Oakridge</p> <p>213500 213509 213510 213515 213516 213517 213518 213521 213522</p> <p>Pleasant Hill</p> <p>180228 180229 180233</p>	<p>Springfield</p> <p>170219 170220 170227 170228 170229 170230 170231 170232 170233 170234 170235 170236 170314 170315 170316 170322 170323 170324 170325 170326 170327 170328 170333 170334 170335 170336 180201 180202 180203 180204 180205 180206 180215 180301 180302 180303 180304 180310 180311 180312</p>	<p>Swisshome</p> <p>170929 170930</p> <p>Trent</p> <p>190201</p> <p>Triangle Lake</p> <p>160717 160718 160719 160720</p> <p>Veneta</p> <p>170530 170531 170532 170625 170635 170636 180506 180601 180602</p> <p>Vida</p> <p>162528 162529 162532</p> <p>Walterville</p> <p>170122 170127 170128</p> <p>Walton</p> <p>180706</p> <p>Westfir</p> <p>212512 213507 213508</p>
---	--	--